

STANDARD SPECIAL (EXPECT EXTENDED DELIVERY TIMES)

ENVIRONMENTAL CONTAINMENT RACKS / STEEL WASH PADS

The Water Maze above ground containment rack systems makes shipping and installing a wash rack easier than ever. With no permitting required, this bolt together system can be installed in a matter of hours.

The low profile modular design with a maximum deck height of 6 inches (15.24 cm) can be purchased in various sizes and configurations to meet your current site requirements. The modular design also allows for shipping under LTL freight rates, or inside of an ocean cargo container for export purposes.

FEATURES AND BENEFITS:

- Multiple Ramp options available:
Drive-On / Back-Off or Drive-Through
- Available in 9' wide and 18' wide models
- Diamond plate deck surface
- Deck height 6"

DRIVE-ON / BACK-OFF CONFIGURATION (18 FEET WIDE MODEL)

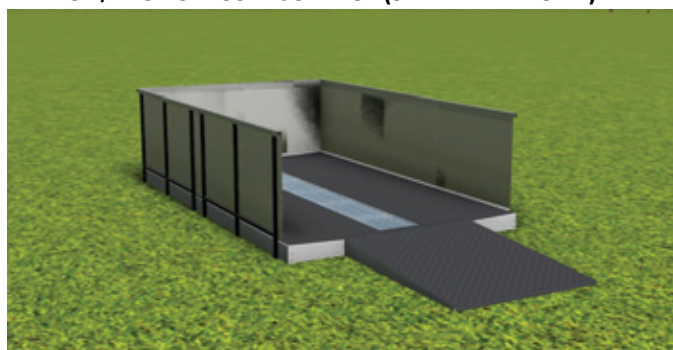
DRIVE-ON / BACK-OFF CONFIGURATION (9 FEET WIDE MODEL)

SHOWN W/ OPTIONAL CANOPY

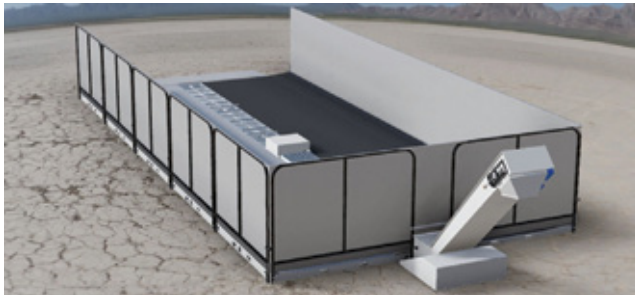
DRIVE-THROUGH CONFIGURATION (18 FEET WIDE MODEL)

CONVEYOR OPTION (FOR 18 FEET WIDE OR GREATER CONTAINMENT RACKS)

STANDARD SPECIALS (EXPECT EXTENDED DELIVERY TIMES)
CONTAINMENT RACK SPECIFICATIONS - 9 FEET WIDE:

DIMENSIONS:	Inside width= 9 feet (2.743 meters), Inside lengths: increments of 7 feet (2.133 meters)
CAPACITY:	15,000 lbs. (6,818 kgs.) weight support distributed over a typical four-wheeled point contact in a 6' x 6' (1828 mm x 1828 mm) area.
MODULAR DECK & TROUGH DESIGN:	Lower deck consists of one section that is 9' (2.743 meters) wide x 7' (2.133 meters) long and incorporates a center trough that is approximately 24" (609 mm) wide x 4.5" (114 mm) deep and includes removable steel gratings that run full length. The outer deck height is 6" (152 mm) high and tapers towards the center trough. Multiple sections are bolted together (using alignment pins and seal strips) to match the overall deck length requirements.
OVERSPRAY WALLS:	6' high tubular steel with galvanized sheet metal.
LAYOUT (options):	<i>Drive-on / back-off</i> with ONE SET of low angle approach ramps and overspray walls on three sides. <i>Drive-through</i> with TWO SETS of low angle approach ramps and overspray walls on two sides.
MATERIALS OF CONSTRUCTION:	Custom U-channel steel fabricated substructure with diamond tread plate surface; tubular steel overspray walls with galvanized sheet metal covering.
METAL FINISHING:	Steel components are deep cleaned with a phosphate cleaning solution and then painted with a 2-step epoxy paint process. Diamond tread deck surface has a grit impregnated coating.

CONTAINMENT RACK SPECIFICATIONS - 18 FEET WIDE:

DIMENSIONS:	Inside width: 18 feet (5.486 meters) Inside lengths: increments of 7 feet (2.133 meters)
CAPACITY:	60,000 lbs. -27,273 kgs. weight support (15,000 lbs. – 6,818 kgs. for typical four-wheeled point vehicle)
MODULAR DECK & TROUGH DESIGN:	Lower deck consists of sections. Section A = 10' wide x 7' long (3.04 m x 2.133 m), and Section B = 8' wide x 7' long (2.438 m x 2.133 m). The 10' wide section incorporates a center trough that is approximately 24" (609 mm) wide x 4.5" (114 mm) deep and includes removable steel gratings that run full length. The outer deck height of each section is 6" (152 mm) high and tapers towards the center trough. Multiple sections of A and B are bolted together (using alignment pins and seal strips) to match the overall deck length requirements.
OVERSPRAY WALLS:	6' high tubular steel with galvanized sheet metal. 12' high tubular steel with outer support braces. (OPTIONAL)
LAYOUT (options):	<i>Drive-on / back-off</i> with ONE SET of low angle approach ramps and overspray walls on three sides. <i>Drive-through</i> with TWO SETS of low angle approach ramps and overspray walls on two sides.
MATERIALS OF CONSTRUCTION:	Custom U-channel steel fabricated substructure with diamond tread plate surface; tubular steel overspray walls with galvanized sheet metal covering.
METAL FINISHING:	Steel components are deep cleaned with a phosphate cleaning solution and then painted with a 2-step epoxy paint process. Diamond tread deck surface has a grit impregnated coating

AVAILABLE OPTIONS:

- **CUSTOM DECK WIDTHS** available upon requests.
- **INTEGRATED UNDERCARRIAGE RINSE SYSTEM:** 60 GPM @ 100 PSI, consisting of:
 - A 10' long spray bar system with 10 spray nozzle pockets welded into the deck plate so all the nozzles are sub surface.
 - The above is embedded into one set of the above deck sections (an "A" and "B" section).
 - A pumping system: centrifugal booster pump with enclosed impellers.
- **DUAL DIAPHRAGM PUMP RECOVERY SYSTEM:**
 - Includes heavy duty suction pumps (x2) that are capable of pumping heavy solids at a flow rate to keep up with the above undercarriage rinse system; flow activation of pumping system using PLC electrical interface with the customer supplied pressure washer and/ or water blaster system; hoses and hose connections from one end of the drain trough to the pump rack.
- **INTEGRATED CONVEYOR SYSTEM:** Automatically removes solids from the center trough system. Available for 18 feet wide or greater containment racks.
- **CANOPY COVERS:** Available to fit all models.
- **TREATMENT & DISCHARGE SYSTEMS**
- **RECYCLE SYSTEMS**